

New Indo Master

Dragons, Mantas and more KOMODO - INDONESIA

Special Group Departure

16 August - 22 August 2024
7 days / 6 nights from Denpasar Bali
from \$4,995 per Diver

Airfares and Taxes

- Flights from Denpasar to Bima and then from Labuan Bajo back to Denpasar (fares subject to change until paid in full and ticketed)
- Includes applicable airline taxes (subject to change)
- NOTE: Let us know if you need help booking flights to Bali

Accommodation & Liveboard details

- Return airport transfers in Bima and Labuan Bajo
- 6 nights twin / double share accommodation aboard in classic or premium cabin "MV Indo Master" Liveboard
- All meals, tea, coffee, fruit juice & soft drinks included
- Up to 4 dives / day, including night dives (except on day of arrival and departure)
- Tanks, weights, guides and dive tenders
- Guided tour on Komodo Island

NOTE: Upgrade to Superior Double cabin with balcony - \$350 pp

Price does not include

- Flights to and from Bali (see note above)
- Travel insurance, personal expenses / Ranger Fees for land excursions
- Marine Park and Port Fee USD 180 - must be paid on board (subject to change)

Booking conditions and requirements:

To secure your place on this trip, please complete an online booking form and return it together with a deposit amount of \$2000.

Package subject to change at any time without notice due to supplier rate changes and exchange rate variations. See other terms & conditions as per the Dive Adventures website

www.diveadventures.com.au

Your on line booking link



One for the bucket list!



Tweed Sea Sports
33 Machinery Drive, Tweed Heads South, NSW 2486
Ph: 07 5524 3683
www.tweedseasports.com



IATA 02341824

Booking Reference : #S28302 Date : 26/02/2024

KOMODO - INDONESIA

Dragons, Mantas and more!



from **\$4995***

Special Group Departure from Denpasar
16 - 22 August 2024



Join us on the voyage of a lifetime aboard the beautiful MY Indo Master to the remote and pristine reefs of Komodo - Indonesia.

Komodo National Park was established in 1980. Initially the main purpose of the Park was to conserve the unique Komodo Dragon and its habitat. The world's largest living lizard can grow over 3 metres and can weigh between 70-150 kilograms. Under the water, the Park has one of the richest marine environments including coral reefs, mangroves, seagrass beds, seamounts, and semi-enclosed bays.





Komodo

Indonesia



P. Sangeang

Flores Sea

Gili Banta

Gili Lawa Laut

Komodo

Current City

Rinca Is.

Nusa Kode

Savu Sea

Indian Ocean



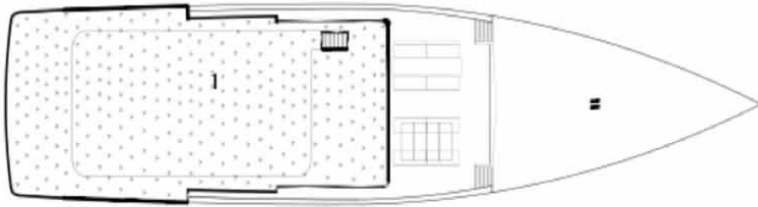

Rooftop



Upper Deck

- 1. Rooftop
- 2&3. Master Suite Double
- 4&5. Master Suite Twin
- 6. CD/TL Room
- 7. Captain Room
- 8. Bridge
- 9. BBQ Lounge

- 10. Diving Deck
- 11. Laundry Room
- 12. Bar
- 13. Kitchen
- 14. Restaurant
- 15. Indoor Lounge
- 16. Outdoor Lounge
- 17 Crew Room
- 18. Engine Room
- 19&20. Suite Double
- 21&22. Suite Twin
- 23. Family Suite



Main Deck

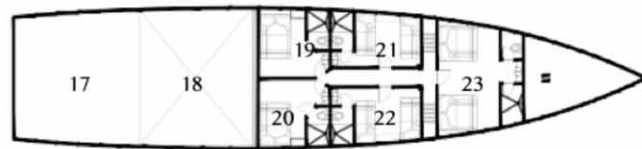

Lower Deck



INDOOR LOUNGE, RESTAURANT AND BAR

